

OYSTER PERPETUAL
DEEPSEA CHALLENGE



ROLEX

WEARING THE WATCH FOR THE FIRST TIME

Before being worn for the first time, or if it has stopped, a Rolex watch must be wound manually in order to function correctly and precisely. To wind the watch manually, unscrew the winding crown completely, then turn it several times clockwise. (Turning in the other direction has no effect.) A minimum of 25 turns is required for adequate partial winding. The watch will then be wound automatically as long as it is worn on the wrist. Carefully screw the crown back down against the case to ensure waterproofness.



The green seal accompanying your Rolex watch is a symbol of its status as a Superlative Chronometer. This exclusive designation attests that it has successfully undergone a series of specific final controls by Rolex in its own laboratories in addition to the official COSC certification of its movement. This unique testing of its chronometric precision, waterproofness, self-winding and reliability pushes back the boundaries of performance and makes Rolex a benchmark for excellence in mechanical watches. For further information, please visit [rolex.com](https://www.rolex.com).



THE HEART OF THE DEEPSEA CHALLENGE MODEL

OYSTER PERPETUAL DEEPSEA CHALLENGE	4-5
HELIUM ESCAPE VALVE	6-7

USING YOUR WATCH

OVERVIEW	8-9
SETTING THE WATCH	10-11
UNIDIRECTIONAL ROTATABLE BEZEL	12-13
ROLEX GLIDELOCK FINE-ADJUSTMENT SYSTEM	14-15
FLIPLOCK EXTENSION LINK	16-17

ROLEX SERVICE

CARING FOR YOUR ROLEX	18-19
AFTER-SALES SERVICE	20-21
WORLDWIDE SERVICE NETWORK	22

ROLEX.COM



ROLEX

**OSTER PERPETUAL
DATE-III SEA-CHALLENGER**



SEA-DWELLER

36090/1 = 11000m

**SUPERLATIVE CHRONOMETER
OFFICIALLY CERTIFIED**

OYSTER PERPETUAL DEEPSEA CHALLENGE

The Oyster Perpetual Deepsea Challenge, guaranteed waterproof to a depth of 11,000 metres (36,090 feet), is created from RLX titanium, a material that is very robust and lightweight. Its patented Ringlock System architecture allows it to resist the pressure at these extreme depths. Its dial offers exceptional legibility thanks to the Chromalight hour markers and hands. The 50 mm case is a paragon of robustness and reliability. The Triplock winding crown, with a triple waterproofness system, is protected by a crown guard that is an integral part of the middle case. The slightly domed

sapphire crystal is 9.5 mm thick and virtually scratchproof.

The Oyster Perpetual Deepsea Challenge is equipped with a self-winding mechanical movement entirely manufactured by Rolex and features an Oyster bracelet with an Oysterlock safety clasp, the Rolex Glidelock fine-adjustment system and a Fliplock extension link.

HELIUM ESCAPE VALVE

Professional saturation divers must spend long periods of time in a decompression chamber, where the gas mixture they breathe is composed of approximately 95 per cent helium. The helium molecules are so small that they penetrate the watch case, with the result that the pressure inside the watch equalizes with that inside the chamber.

During the decompression phase that slowly brings the diver back to normal atmospheric pressure, the gas cannot always escape from the case sufficiently

quickly. The resulting excess internal pressure risks damaging the watch.

To solve the problem, the Oyster Perpetual Deepsea Challenge is equipped with a helium escape valve allowing the gas trapped inside the watch to be released without affecting the integrity and waterproofness of the Oyster case.



OVERVIEW

- 1 Hour hand
- 2 Minute hand
- 3 Seconds hand
- 4 Unidirectional rotatable bezel
with 60-minute graduated Cerachrom
insert in ceramic
- 5 Triplock winding crown with
triple waterproofness system
- 6 Helium escape valve

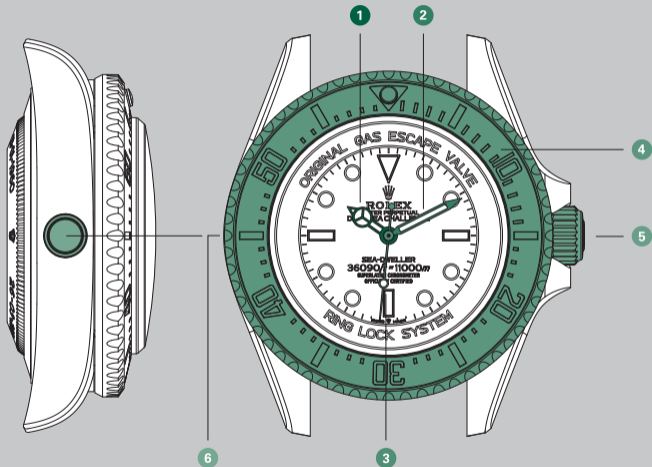

SETTING THE WATCH

Screwed-down position (*position 0*)

The crown is completely screwed down against the case. When the crown is in this position, the Oyster Perpetual Deepsea Challenge is guaranteed waterproof to a depth of 11,000 metres (36,090 feet).

Manual winding (*position 1*)

The crown is unscrewed. To wind the watch manually, turn the crown clockwise; turning in the other direction has no effect. When setting the watch

for the first time or after the watch has stopped, complete a minimum of 25 turns for partial winding.

Setting the time (*position 2*)

The crown is unscrewed and pulled out to the first notch. The seconds hand is stopped, allowing you to set the time to the precise second. To set the hour and minute, turn the crown in either direction.

Initial winding and setting

- A. Wind the watch manually (*position 1*).
- B. Set the time (*position 2*).

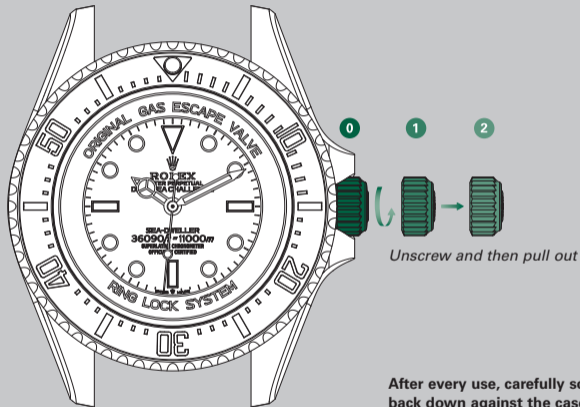

After every use, carefully screw the crown back down against the case to guarantee the waterproofness. Return the crown to *position 1* and apply light pressure on it while screwing it down clockwise against the case. The crown should never be unscrewed underwater.



ORIGINAL GAS ESCAPE VALVE

ROLEX
PERPETUAL
DEA CHALLENGE

UNIDIRECTIONAL ROTATABLE BEZEL

The Oyster Perpetual Deepsea Challenge allows divers to safely monitor their dive time thanks to the unidirectional rotatable bezel. This bezel is fitted with a 60-minute graduated Cerachrom insert made of ceramic, a material that is resistant to environmental effects.

Before the dive

Before beginning your descent, turn the bezel until the triangle on the graduation is opposite the minute hand. It indicates the beginning of the dive and is visible in the dark thanks to a phosphorescent capsule.

During the dive

The duration of the dive is indicated on the graduation on the Cerachrom insert by the minute hand.

For safety reasons, the bezel turns only counterclockwise. Accidental rotation of the bezel can therefore only shorten the dive time.

ROLEX GLIDELOCK FINE-ADJUSTMENT SYSTEM

On the Oyster bracelet, the Rolex Glidelock fine-adjustment system enables the bracelet length to be adjusted in approximately 2 mm increments up to around 20 mm, allowing the watch to be worn over a diving suit.



Adjustment of the bracelet

- 1 Open the safety catch
- 2 Lift the centre panel
- 3 Slide the bracelet to the desired length
- 4 Push the centre panel back down
- 5 Close the safety catch

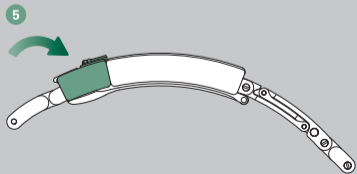
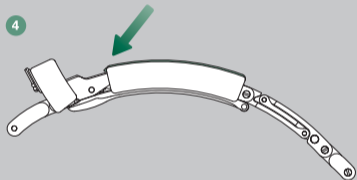
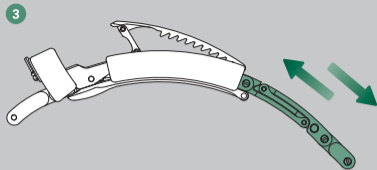
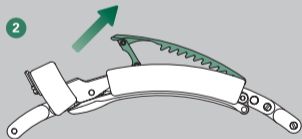
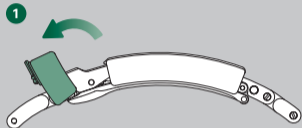

FLIPLOCK EXTENSION LINK

The Fliplock extension link allows the bracelet length to be increased by an additional 26 mm approximately, for wear over a thicker diving suit.

Opening the Fliplock extension link

- 1 Remove the watch from your wrist and fully extend the bracelet using the Rolex Glidelock fine-adjustment system (*see pages 14-15*)
- 2 Press the extension link on both ends at once to open it

Closing the Fliplock extension link

- 1 Fold the link
- 2 Press down the clasp side first
- 3 Click down the link on the bracelet side while pressing down on both ends of the link

To open

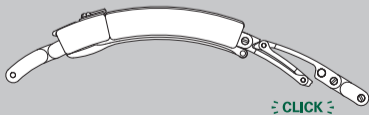
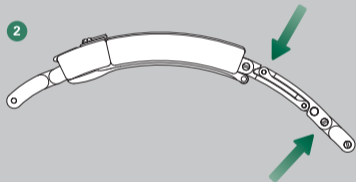
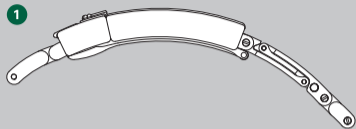

To close



CARING FOR YOUR ROLEX

Thanks to Rolex expertise, your watch will require very little day-to-day care.

You can help preserve its lustre by cleaning it occasionally with a microfibre cloth. You can also wash the case and bracelet from time to time using soapy water and a soft brush. After wearing your watch in the sea, it is important to rinse it with fresh water to remove any salt and sand deposits.

Before cleaning your watch, always ensure that the crown is screwed down properly against the case to guarantee waterproofness.

AFTER-SALES SERVICE

Rolex watch servicing ensures that your timepiece will continue to perform optimally and meet Rolex's stringent requirements in terms of precision, reliability and waterproofness throughout its life.

The timekeeping accuracy of your watch is largely dependent on high-performance lubricants specially developed by Rolex to minimize friction and prevent wear of components. To guarantee continued accuracy and waterproofness, Rolex recommends that you periodically return your watch to an Official Rolex Retailer or

Service Centre for professional servicing, which will always be carried out by a Rolex-approved watchmaker.

During a complete service, the watch is dismantled and all of its components – the case, bracelet and movement – are closely examined.

The movement is entirely disassembled and all the parts are carefully inspected. Those that no longer meet Rolex requirements are systematically replaced by new components. The movement is lubricated on reassembly. The case

and bracelet are re-polished or satin-finished according to their original finish, restoring their shine and lustre while removing any marks or scratches.

At the end of the process, your Rolex watch undergoes a series of tests to verify its functions, waterproofness and power reserve, as well as the precision of its movement.

After a complete Rolex service, your watch is covered by a service guarantee.

WORLDWIDE SERVICE NETWORK

The network of Official Rolex Retailers and Service Centres covers more than 100 countries around the world and draws on the expertise of highly skilled watchmakers, carefully selected and trained by Rolex.

Official Rolex Retailers can advise you on all the technical aspects of your watch's functions. Whether your bracelet needs sizing or it is time for a complete service, highly qualified Rolex watchmakers are on hand worldwide to meet all of your service needs.

For a list of Official Rolex Retailers and Service Centres, please visit [rolex.com](https://www.rolex.com).

ROLEX.COM

We invite you to visit **rolex.com**,
a privileged place to learn more about
the functions of your Rolex watch
and about the quality, know-how and
fundamental values of the brand.

Welcome to the world of Rolex.

Rolex reserves the right to modify the models illustrated in this publication at any time.

© Rolex SA, 3-5-7, rue François-Dussaud, 1211 Geneva 26, Switzerland
IMR-DC-EN-20 - 4.2020 - Printed in Switzerland

[rolex.com](https://www.rolex.com)

